

Futura 36W/39W Compact Fluorescent

PW940_139_HE

1.2



Wall Sconces

GENERAL PRODUCT INFORMATION:



This product can mount to either a 4" square electrical box with round plaster ring or an octagon electrical box.

This product is suitable for indoor dry locations only.

CAUTION - RISK OF FIRE
 This product requires installation by a qualified electrician. Before installing be sure to read all instructions and **TURN THE POWER TO THE ELECTRICAL BOX OFF.**



Install the Fixture

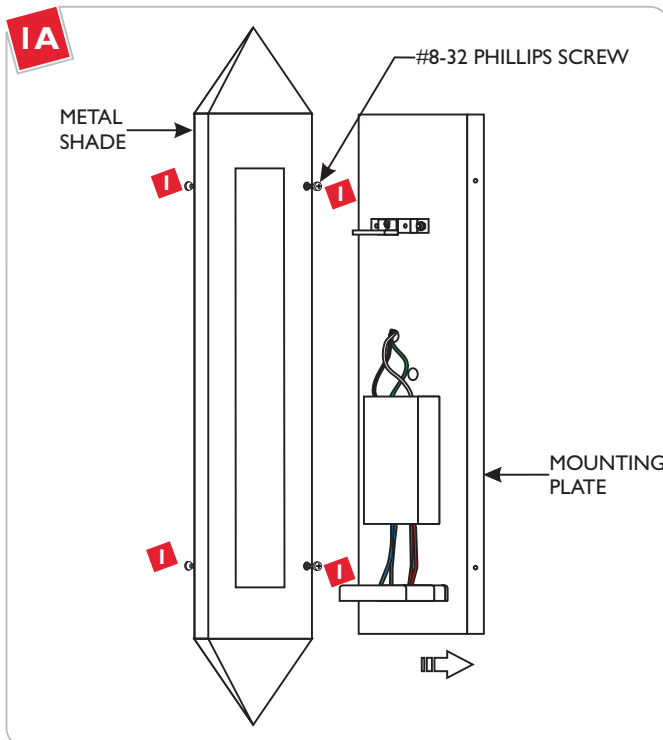

- 1** Unscrew and remove the four #8-32 Phillips screws from the metal shade sides.
- 2** Remove the mounting plate.

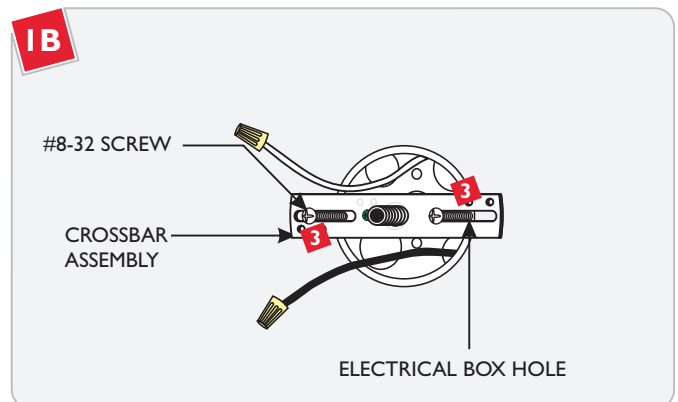

- 3** Mount the crossbar assembly to the electrical box holes with the two #8-32 screws provided.

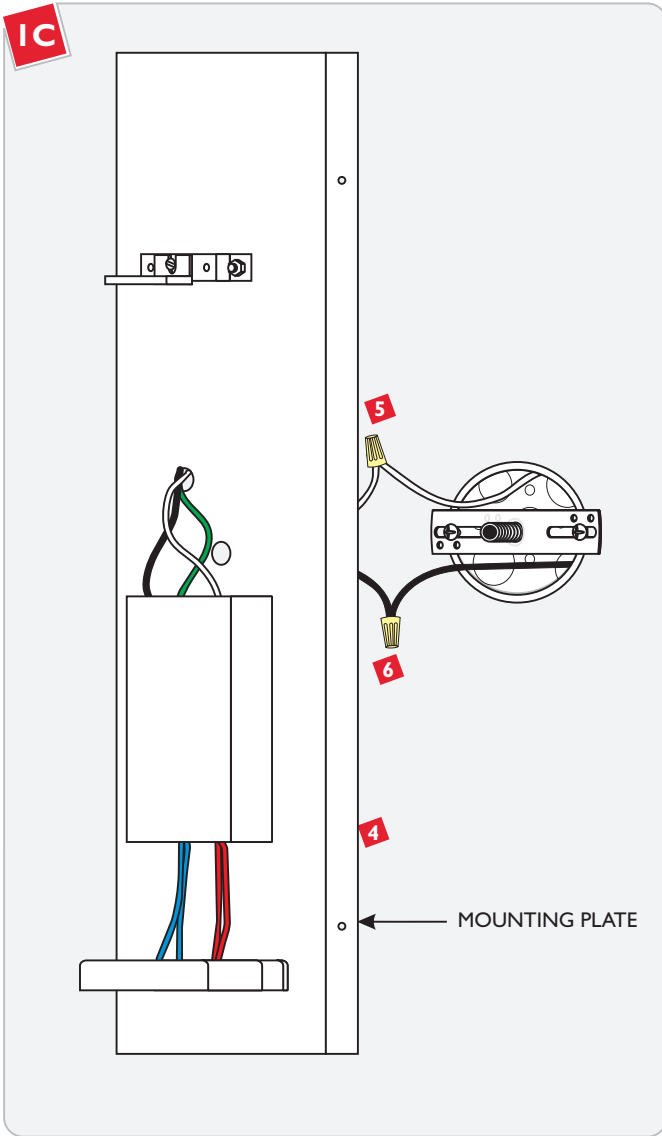

- 4** In accordance with local electrical codes, make sure that the mounting plate is grounded.
- 5** Connect the fixture white wire to the neutral power line wire with a wire nut.
- 6** Connect the fixture black wire to the hot power line wire with a wire nut.

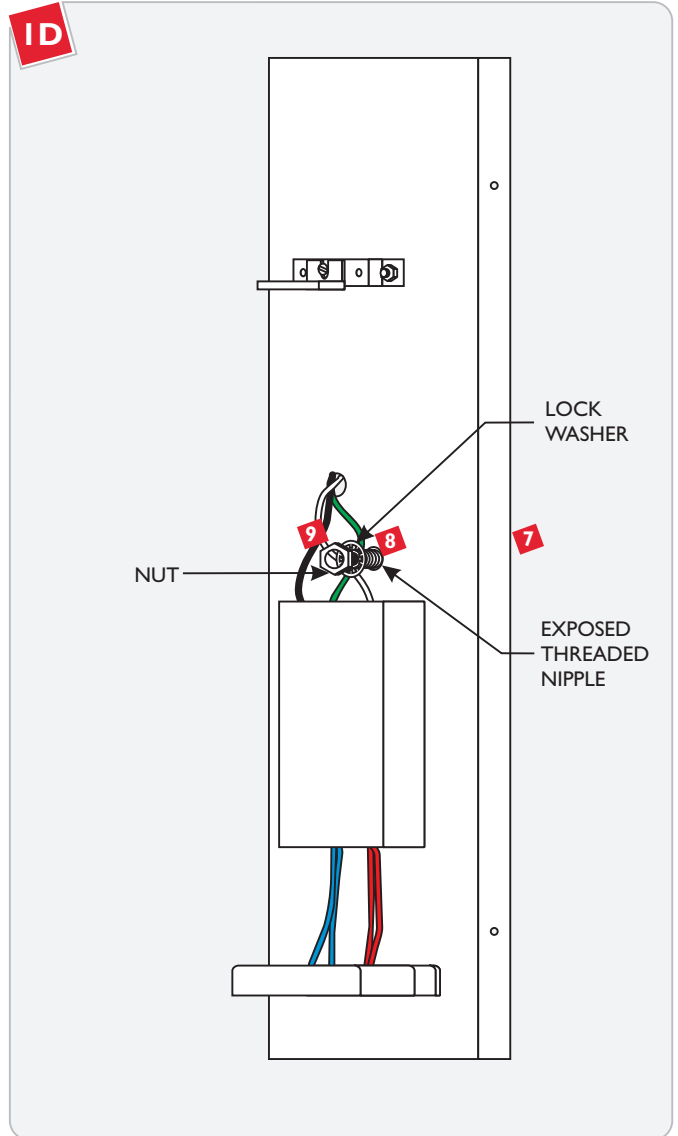

- 7** Place all wires and wire nut connections properly inside the electrical box.
- 8** Level the mounting plate vertically and slide the center hole completely onto the exposed threaded nipple.
- 9** Secure the mounting plate to the threaded nipple with lock washer and nut.

Install the Lamp & Shade

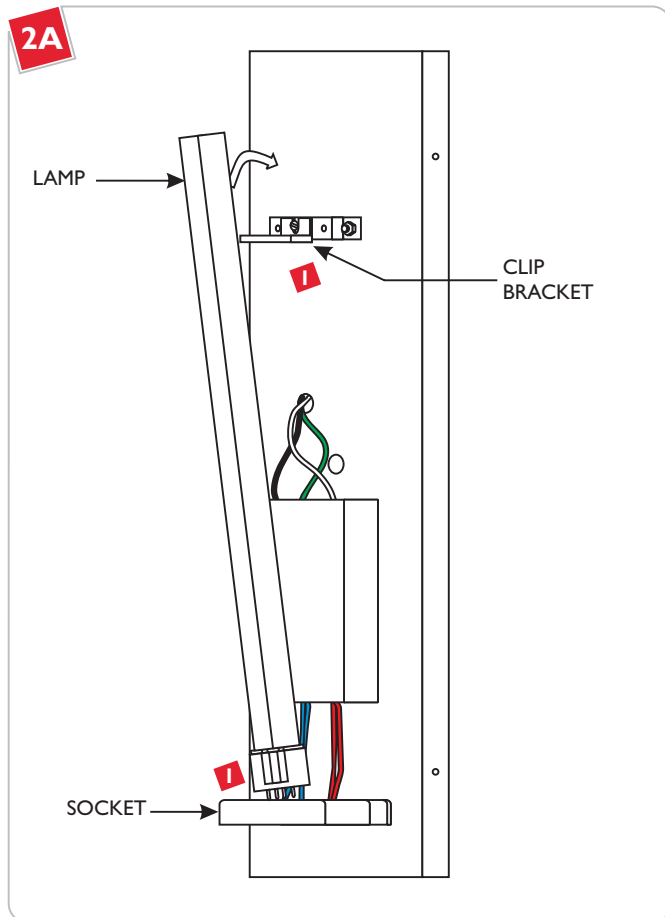

NOTE: To reduce the risk of a burn or electric shock during relamping, disconnect the power to the fixture by turning the wall switch off.

Use **MAX** 39 Watt type 2G11 Base Compact Fluorescent Lamp.



A 36 Watt (Recommended) type 2G11 Base Compact Fluorescent Lamp is provided with the fixture.

- 1 Push the lamp pins completely into the socket holes and secure by snapping into the clip bracket.

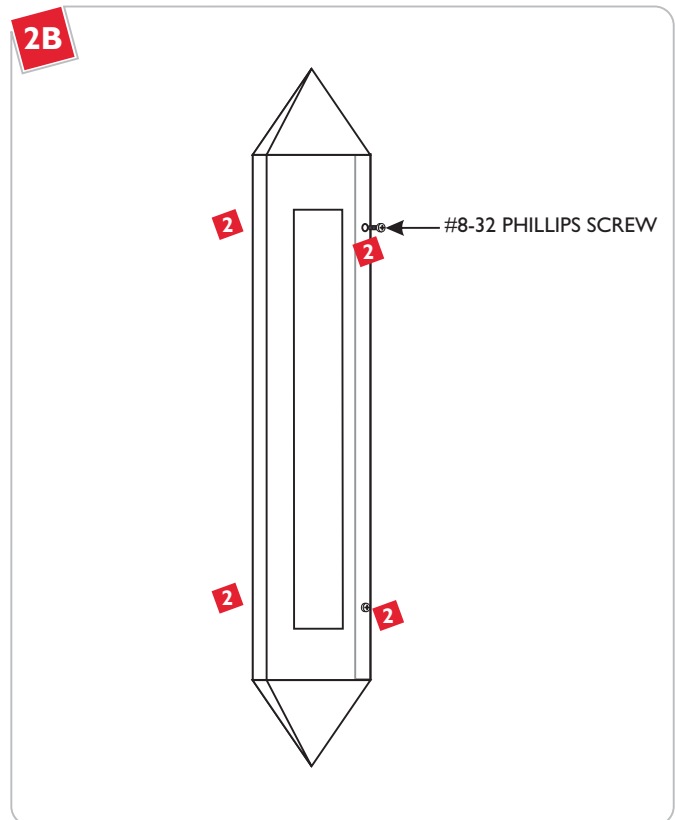

- 2 Align the metal shade holes with the mounting plate side holes. Replace and tighten the four #8-32 Phillips screws to secure the metal shade in place.

SAVE THESE INSTRUCTIONS!



7400 Linder Ave, Skokie, IL 60077

800.323.3226 - 847.626.6300

www.lblighting.com

© 2008 LBL Lighting. All rights reserved. The "LBL Lighting" graphic is a registered trademark of LBL Lighting. LBL Lighting reserves the right to change specifications for product improvements without notification.

A Generation Brands Company