

# VAIO DUO 3 VAIO DUO 3 WITH MOULDED PANEL

- attractive corner bathtub with distinct arm rest which can also be used as a seat
- bathing with a friend: two identical back rests and centrally positioned outlet
- made of Kaldewei steel enamel 3.5 mm
- also available with panel

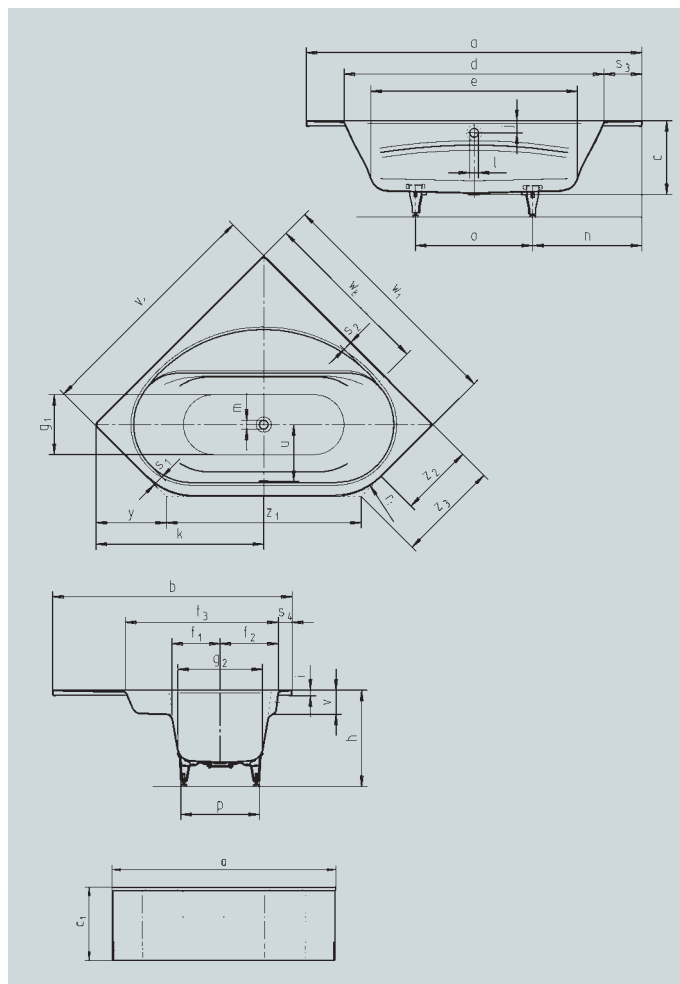

Model no.		962	962-7
External length	a	1961	1961 mm
External width	b	1401	1401 mm
Overall height with panel	c <sub>1</sub>	–	560 mm
Depth	c	430	430 mm
Internal length (top)	d	1522	1522 mm
<b>Internal length (bottom)</b>	<b>e</b>	<b>1206</b>	<b>1206 mm</b>
Internal width (top) bathing area; incl. armrest	f <sub>1</sub> ; f <sub>2</sub> ; f <sub>3</sub>	282; 340; 855	282; 340; 855 mm
Internal width (bottom)	g <sub>1</sub> ; g <sub>2</sub>	353; 496	353; 496 mm
Height with feet	h	550-590	550-590 mm
Height of rim	i	32	32 mm
Distance top edge to centre of overflow hole	j	70	70 mm
Distance tub edge to centre of drain hole	k	980	980 mm
Diameter of overflow hole	l	52	52 mm
Diameter of drain hole	m	52	52 mm
Distance foot end of tub edge to centre of foot	n	680,5	680,5 mm
Distance between the feet	o	600	600 mm
Max. width of feet	p	455	455 mm
Radius	r <sub>1</sub>	400	400 mm
Width of rim (foot end; lengthwise; diagonal)	s <sub>1</sub> ; s <sub>2</sub> ; s <sub>3</sub> ; s <sub>4</sub>	62; 55; 219; 80	62; 55; 219; 80 mm
Distance between centre holes	u	332	332 mm
Armrest depth	v	140	140 mm
Side length	v <sub>1</sub>	1400	1400 mm
Side width	w <sub>1</sub>	1400	1400 mm
Narrowest point (for wall inlet fittings)	w <sub>8</sub>	1000	1000 mm
Fase	y	410,5	410,5 mm
Side length	z <sub>1</sub> ; z <sub>2</sub> ; z <sub>3</sub>	1140; 428; 594	1140; 428; 594 mm
Water volume** in litres		125	125
Weight of the enamelled bath tub in kg		53	–
Anti-slip		–	–
Full anti-slip		–	–

Subject to technical alterations and tolerances.  
\*\* 70 litres displacement on average.