

Family: Pearl | Item No. 1366 BK

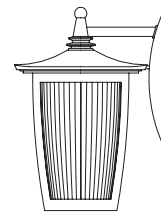

Drawing 1 - Strap Detail

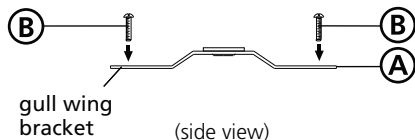

Drawing 2 - Glass Installation

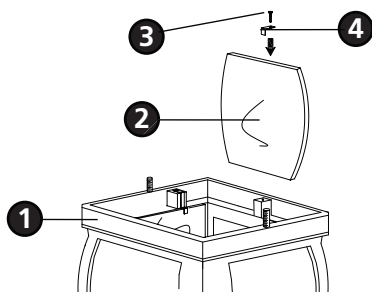

Drawing 3 - Fixture Mounting

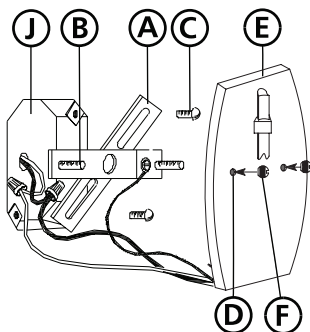

Drawing 4 - Fixture Lamping

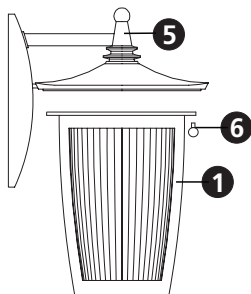

▼ start here

1

1. Find a clear area in which you can work.
2. Unpack fixture and glass from carton.
3. Carefully review instructions prior to assembly.

***** The construction of this fixture will be accomplished by first installing the glass in the fixture cage, installing the mounting strap to the junction box, making all necessary electrical connections, and then mounting the fixture to the wall.**

2

1. Prepare mounting strap (A) by threading the two long mounting screws (B) into the back of the gull wing bracket - see **Drawing 1**.
 - Be sure the holes into which the screws are threaded match the spacing of holes (D) in the back plate (E) - see **Drawings 1 and 3**.
2. Attach mounting strap (A) to junction box (J) using two 1" screws (C) - see **Draw-**

3

1. To install glass, separate cage (1) from roof (5) by removing slotted ball knobs (6) under the roof edge. Now locate the glass clips (4) on the inside top edge of the cage (1) - See drawing 4.
2. Remove glass clip screw (3) and glass clip (4), located on the top edge of the cage (1), using a phillips screw driver - see Drawing 2.
3. Slip glass panels (2) into cage (1), make sure bottom edge is in front of tab located in the bottom of the cage.
4. Replace glass clip (4) and glass clip screw (3), to secure glass. Repeat for remaining panels.
5. Replace cage (1) with glass back onto roof (5) slotted ball knob screws removed in step 1.

SAFETY WARNING: READ WIRING AND GROUNDING INSTRUCTIONS (I.S. 18) AND ANY ADDITIONAL DIRECTIONS. TURN POWER SUPPLY OFF DURING INSTALLATION. IF NEW WIRING IS REQUIRED, CONSULT A QUALIFIED ELECTRICIAN OR LOCAL AUTHORITIES FOR CODE REQUIREMENTS.

Make electrical connections from supply wire to fixture lead wires. Refer to instruction sheet (I.S. 18) and follow all instructions to make all necessary wiring connections. Then refer back to this sheet to continue installation of this fixture.

4

1. To mount fixture, slide backplate (E) over screws (B) and secure with ball knobs (F) - see **Drawing 3**.

5

1. To lamp fixture remove slotted ball knobs (3) from under roof (1), hold cage (2) in position - see **Drawing 3**.
2. Drop cage (2) to expose socket and lamp fixture accordingly.
3. Follow step 1-2 in reverse order to re-assembly fixture.

Note: Maximum wattage for 1366 fixture is 60 watts per bulb.

2.7.08