

Model 610 Mesh "AirFlo" Task Chair

Parts Listing

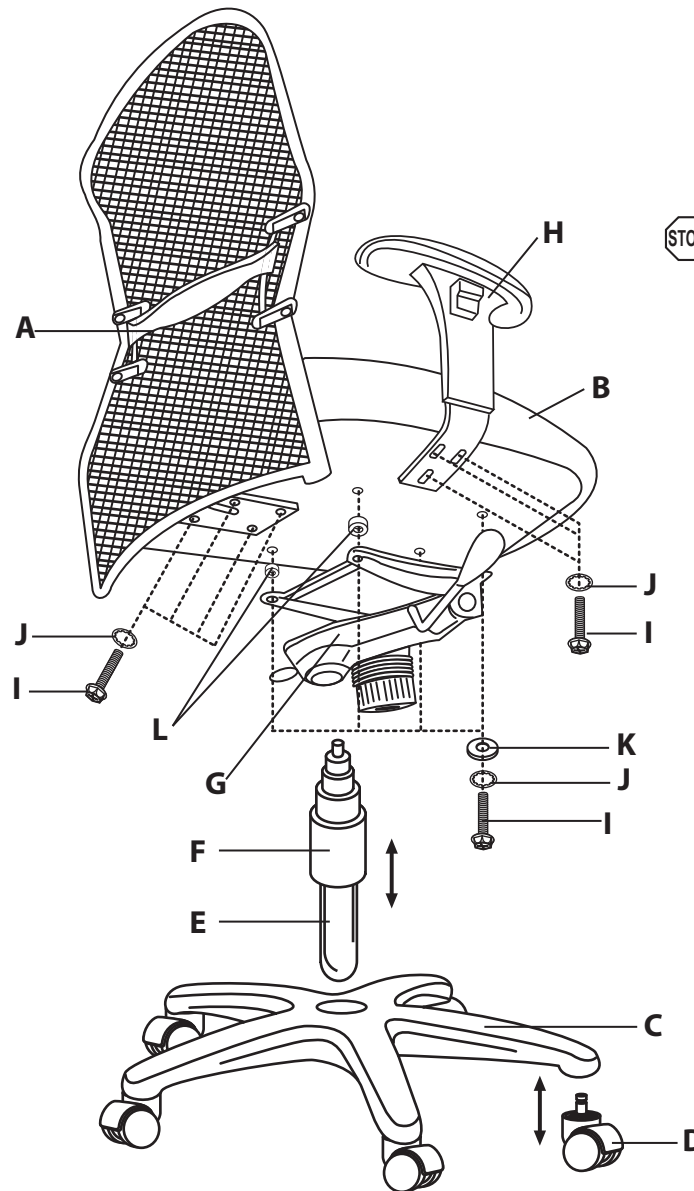
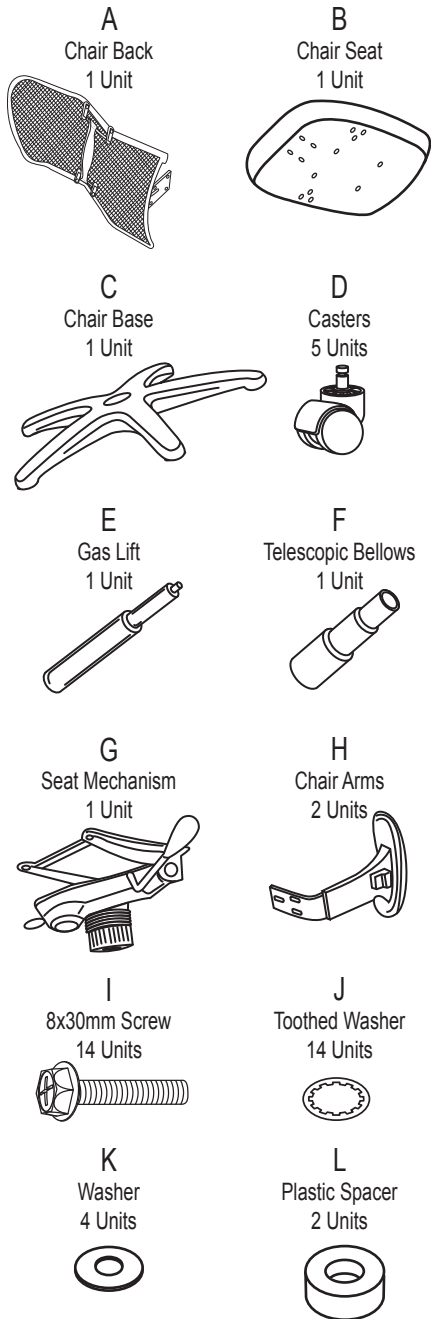

WEIGHT CAPACITY: 250 lbs.

Assembly Notes:

During assembly, hand tighten screw only when all screws are in place, you may then tighten all screws completely.

CAUTION:

1. Do not use this chair as a step ladder.
2. Check for loose screws and tighten them every 6 months.

Assembly Instructions



Tools Needed: Phillips Head Screwdriver
Please read all instructions before assembly.

- Step 1:** Insert Casters (D) into Chair Base (C).
- Step 2:** Insert Gas Lift (E) into the hole in the center of the Chair Base (C) and cover with Telescopic Bellows (F).
- Step 3:** Place Chair Seat (B) upside-down on a level, non-abrasive surface. Place two Plastic Spacers (L) on the back two mechanism holes in the Chair Seat (B).
- Step 4:** Place Seat Mechanism (G) on Chair Seat (B) and align the holes in the mechanism with the holes in the Chair Seat (B). The back two holes in the Mechanism (G) should also line up, and sit on top of, the holes in the Plastic Spacers (L).
- Step 5:** Place one Toothed Washer (J) and one Washer (K) on each of four 8x30mm Screws (I) in order as shown. Insert these screws through the holes in the Seat Mechanism (G) and into the Chair Seat (B). The back two screws should also be inserted through the Plastic Spacers (L) as shown.
- Step 6:** Attach Chair Back (A) to Chair Seat (B) using Toothed Washers (J) and 8x30mm Screws (I).
- Step 7:** Attach Chair Arms (H) to Chair Seat (B) using Toothed Washers (J) and 8x30mm Screws (I).
- Step 8:** Carefully sit on chair to make sure the Gas Lift (E) is properly inserted into the base. Operate the gas lift lever on the Seat Mechanism (G) to be sure unit is working.

ofm
Furniture For The Real Office™

161 Tradition Trail Holly Springs, NC, 27540
800-520-7471 (voice) 919-362-4765 (fax)
919-303-6389 (voice) www.ofminc.com
support@ofminc.com