

CS100

WALL MOUNT COMPONENT SHELF INSTRUCTION MANUAL

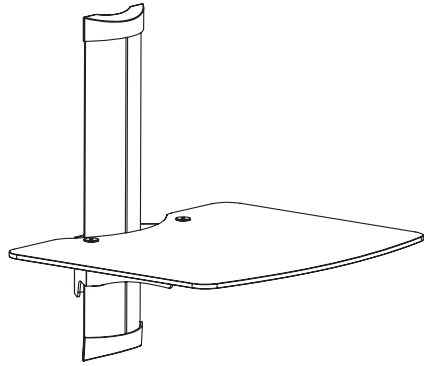

Single adjustable tempered glass wall shelf system
Weight capacity per shelf : 30lbs (13.6kg)
Integrated cable management

Parts List:

- ①- (4mm)-1 pcs
- ②- (Ø14xØ6.2x1.5)-2 pcs
- ③- (M6x15)-2 pcs
- ④- (M6x10)-2 pcs
- ⑤- (M6x50)-2 pcs
- ⑥- (Ø10xØ6x50)-2 pcs

Not included other necessary tools.

step 1

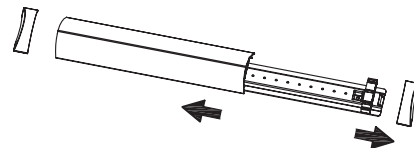

step 2A

When mount on wood stud(2" x 4" inch)(51x102mm).

No wall anchors ⑥.

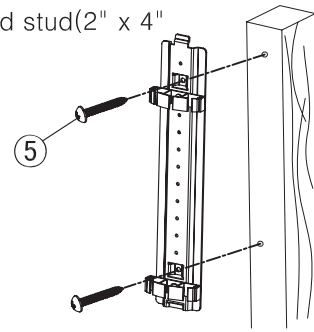
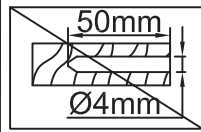

step 2B

When mount on masonry (solid concrete).

Use wall anchors ⑥.

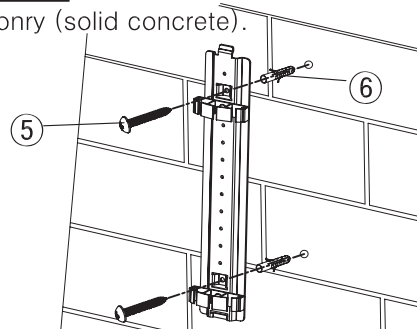
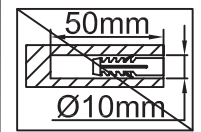

step 3

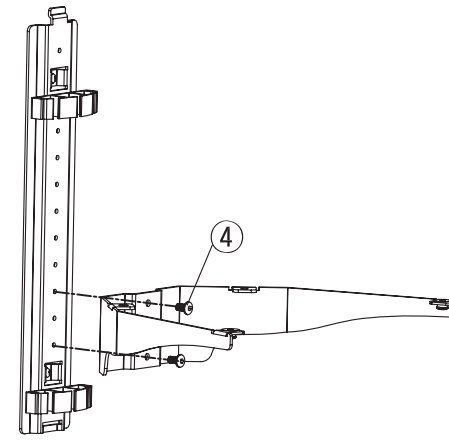

step 4

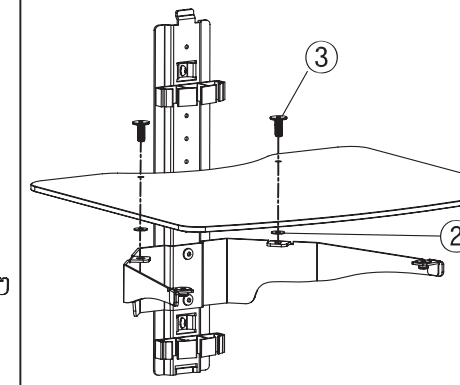

step 5

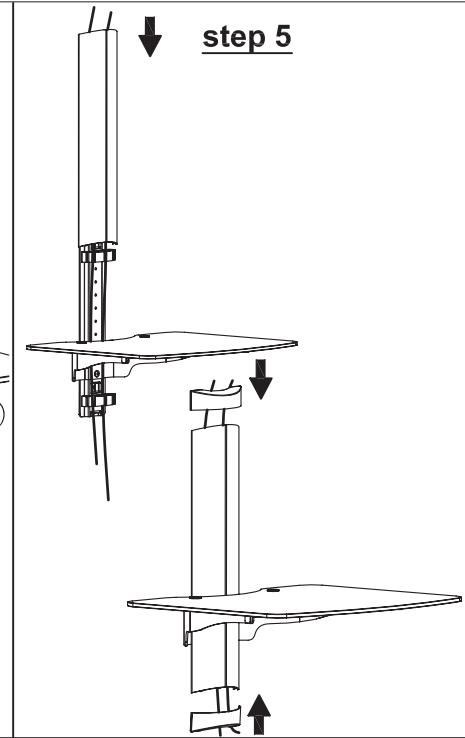

To mount 2 Cs100 for a Dual Shelf System

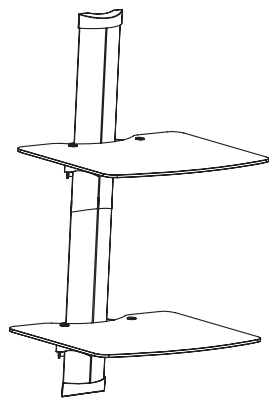

Requires two (2) Cs100 Shelf Systems.

Double adjustable tempered glass wall shelf system
Weight capacity per shelf : 30lbs(13.6kg)
Integrated cable management

NOTICE!

This Configuration will require using two (2) Cs100 Shelf Systems.

Items needed:

Cs100 Component Shelf System X 2

step 1

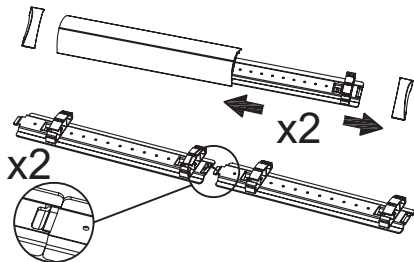

step 2A

When mount on wood stud(2" x 4" inch)(51x102mm).

No wall anchors ⑥.

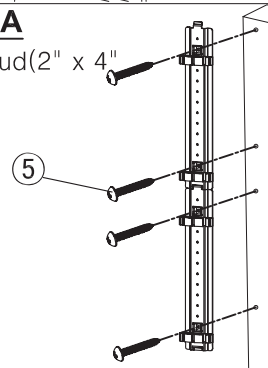
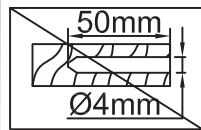

step 2B

When mount on masonry (solid concrete).

Use wall anchors ⑥.

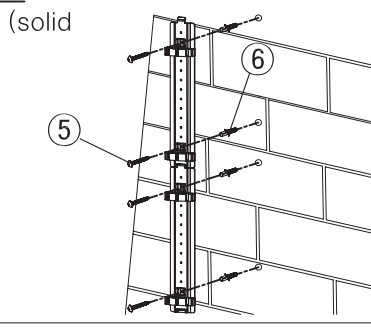
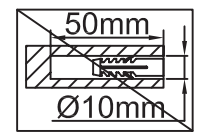

step 3

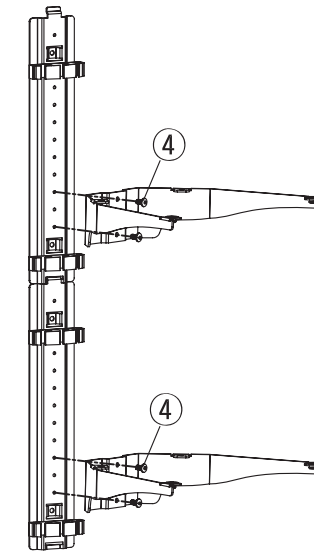

step 4

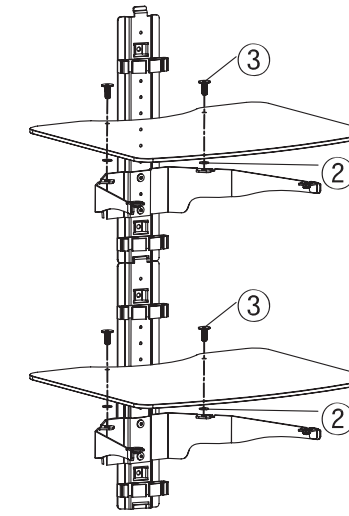

step 5

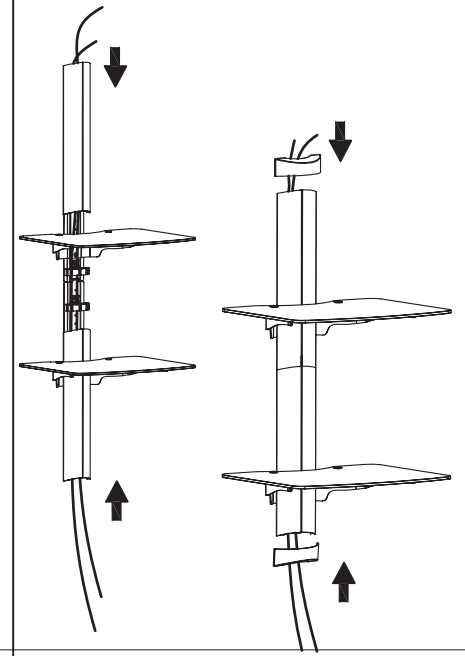

To mount 3 CS100 for a Triple Shelf System

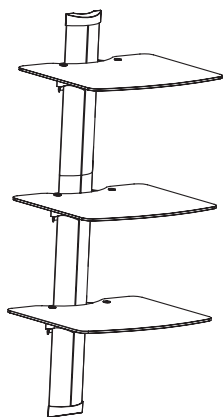

Requires three (3) CS100 Shelf Systems.

Triple adjustable tempered glass wall shelf system
Weight capacity per shelf : 30lbs (13.6kg)
Integrated cable management

NOTICE!

This Configuration will require using three (3) CS100 Shelf Systems.

Items needed:

CS100 Component Shelf System X 3

step 1

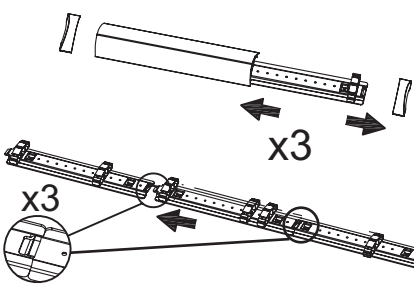

step 2A

When mount on wood stud(2" x 4" inch)(51x102mm).

No wall anchors ⑥.

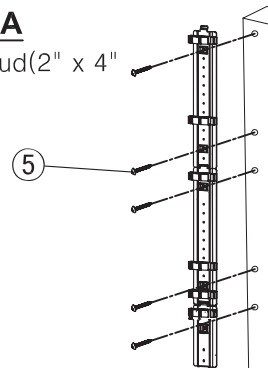
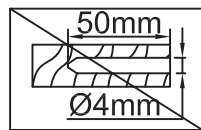

step 2B

When mount on masonry (solid concrete).

Use wall anchors ⑥.

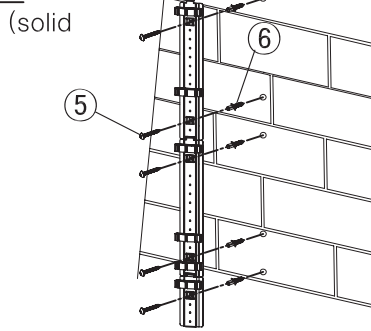
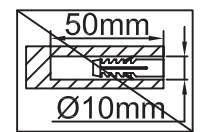

step 3

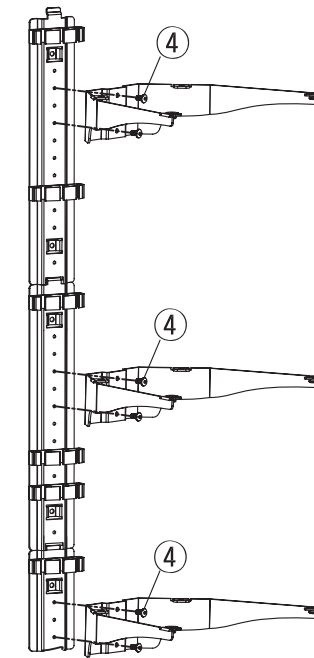

step 4

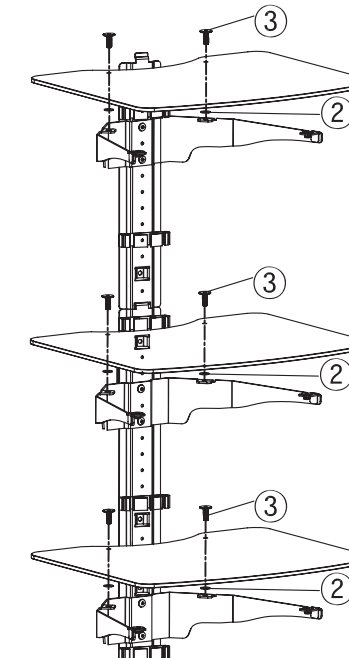

step 5

